

Pentkhaus

Premium Lifestyle Called The Addition

United Arab Emirates, Dubai, Dubai, Meyappa Chettiar Rd, 21, 358461,

 55 qm

 3 kimnaty

 2 spal?ni

 1 vanni kimnaty

 1 poverhy

 1 qm zemel?na
ploshcha

 1 avtomobil?ni
mistsya



Maureen Neo

Hutton

Singapore, Singapore - Mistsevy Chas



+65 9817 0028

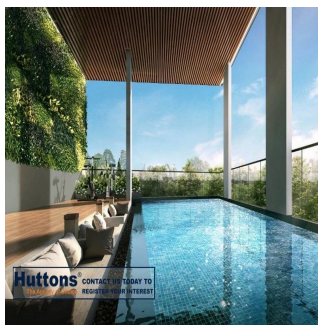

A new address that will provide a premium lifestyle called The Addition is being created at 21 Meyappa Chettiar, District 13, Singapore. This project is designed by JGP Architecture(S) Pte Ltd and is being developed by the well known real estate company Oxley Topaz Pte Ltd. This condominium, when completed in 2023, will be a single block of 8 stories containing 26 fully furnished residential units. The Addition due to its location and a range of convenient facilities is an attractive investment choice. Residents will enjoy a peaceful and agreeable lifestyle with all that is required within easy reach. Some of the features that make this condo project so alluring are listed. A rare freehold development. A short distance to the Potong Pasir MRT. Will be equipped with a sophisticated smart home system for great comfort and security. An easy drive to the city centre. A short drive to the MacPherson industrial area. Near many reputable educational institutes (St Andrews junior/secondary school, St Andrews Junior College and others). A short distance to various shopping centres, shopping malls and parks (Nex Shopping Mall, East Coast Park, Garden by the Bay). Very near the Pan Island Expressway (PIE). Well positioned for Changi Airport.

Dostupnyy Z: 09.08.2019

Poverkh: 4 Poverkhy: 4 Rik Pobudovy: 2017 Avtomobil?Ni
Mistsya: 4

Rik Pobudovy: 2017

Typ: Ofis



Zruchnosti

ID	ID majna
----	----------

Zruchnosti Na Vidkrytomu Povitri