

Pentkhaus

Wallich Residence In Tanjong Pagar Centre

???????, ???? , ???? , Wallich St, 3 ,

- qm
- 0 kimnaty
- 0 spal?ni
- 0 vanni kimnaty
- 0 poverhy
- 0 qm zemel?na ploshcha
- 0 avtomobil?ni mistsya



Melvin Lim

Property Lim Brothers

Singapore, Singapore - Mistsevyv Chas

+65 90676710

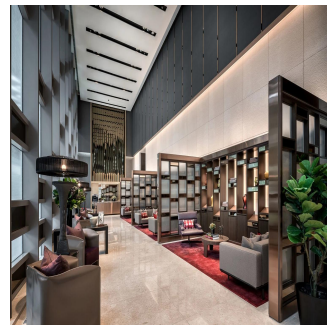
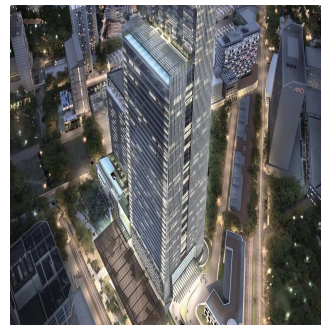
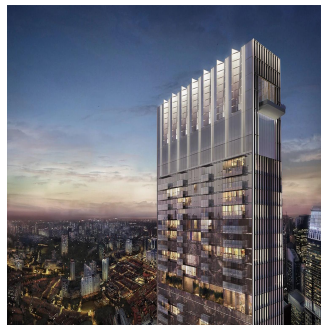

Wallich Residence occupies the highest floors of Tanjong Pagar Centre, an ambitious vertical city that comprises a dynamic mix of commercial, residential, retail, hotel and urban park components. Rising directly above Tanjong Pagar MRT station, this new global icon is set to position Tanjong Pagar as the premier business and lifestyle district in the CBD. Wallich Residence is part of the latest visionary development by GuocoLand, a leading regional property company that places quality, innovation and environmental sustainability at the core of every project. GuocoLand's portfolio of premium residential, hospitality, commercial, retail and integrated developments region-wide includes 34 residential projects in prime districts in Singapore. With four levels of amenities, from the hotel-inspired Wallich Concierge Service and the stunning infinity pool at level 39, to the private library on level 52 and breathtaking observation platforms on level 62, Wallich Residence is a tower that stands apart. Not just by its sheer height, but also by the quality of the life one experiences here. Infinity Pool Dipping Pool Casual Dining Room Gourmet Dining Room Glass Viewing Deck Theatre Gym BBQ Jacuzzi Sky Garden Cabanas Library

Dostupnyy Z: 05.08.2019

Poverkh: 4 Poverkhy: 4 Rik Pobudovy: 2017 Avtomobil?Ni Mistsya: 4 Rik Pobudovy: 2017 Typ: Ofis



Zruchnosti

ID ID majna

Zruchnosti Na Vidkrytomu Povitri