

Pentkhaus

Luxurious Contemporary Living On The Banks Of The Maribyrnong River

Maribyrnong St, 4, 3011,

- qm
- 0 komnaty
- 0 spal'ni
- 0 vannyye komnaty
- 0 etazhi
- 0 qm Ploshchad'
- 0 mesta dlya zemel'nogo uchastka mashin



Adrian Chen
 Jalin Realty Australia
 Melbourne, Australia - Mestnoye Vremya

+61 414 174 765

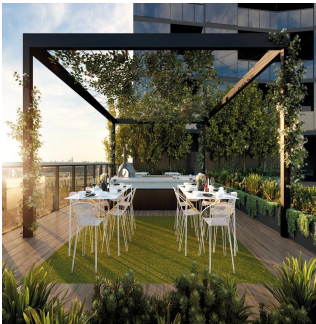

With absolute river frontage, Waterfront invites you to experience exceptional architectural design in a unique inner city location. Designed by award-winning firm CHT Architects and inspired by the Maribyrnong's charming riparian environment, Waterfront reflects the neighbourhood's rich marine heritage in a striking, glass podium facade. Conceptually drawing on the waterway tributary systems and embracing the natural environment, Waterfront offers multiple spaces that allow residents to experience the beauty of the riverfront to its fullest. Just 6km from the CBD, and on the banks of the magnificent Maribyrnong River, Melbourne's multicultural heart is drawing plenty of attention from both investors and lovers of its abundant cultural and lifestyle attractions.

Dostupna S: 15.07.2019

Pol: 4 Etazhi: 4 God Postroyki: 2017 Avtomobil'nyye Prostranstva: 4 God Postroyki: 2017 Tip: Ofis



Udobstva

Ya sdela eto

ID Svoystva

Naruzhnyye Udobstva