

Penthouse

# Spacious Two Bedroom Residences In Development

Warrigal Rd, 37-41, 3166,

VERKOOPPRIJS

**USD 570000.00**

- 🏠 qm
- 🏠 4 kamers
- 🛏 2 slaapkamers
- 🚿 2 badkamers
- 🏠 2 vloeren
- 📏 2 qm Landoppervlak
- 🅇 2 Parkeerplaatsen



**Michael Lang**

Castran Gilbert

South Yarra, Australia - Plaatselijke tijd

+61 407 766 771

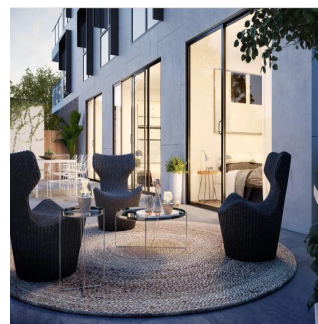

• ONLY 5% DEPOSIT PAYABLE FOR A LIMITED TIME! • Stunning selection of spacious two bedroom residences • All with secure car parking & additional storage • Architecture by The Buchan Group • Close to parklands, shops, eateries & public transport • Under construction, estimated completion November 2019 Situated in the vibrant Hughesdale-Oakleigh precinct, HUE delivers a lifestyle of utmost effortlessness and accessibility. Featuring a striking contemporary design by The Buchan Group, the spacious two bedroom residences deliver light-filled open plan living spaces, serene courtyards and generous terraces, designer kitchens with stone bench tops and European appliances, timber flooring and other high quality appointments. Each residence is further accompanied by one or two secure car spaces on title, plus additional storage. HUE enjoys the convenience of having shops, eateries and every conceivable amenity at its doorstep. For those seeking a world-class retail experience, Chadstone Shopping Centre is just a quick 5-minute drive away. Construction is currently underway, with completion estimated for November 2019. Don't miss out – enquire now.

Verkrijgbaar Bij: 16.07.2019

Vloeren: 4 Vloeren: 4 Bouwjaar: 2017 Parkeerplaatsen: 4 Bouwjaar: 2017

Type: Kantoor



## Voorzieningen

ID Identificación de la propiedad

## Voorzieningen Buitenshuis