

Penthouse

36 Luxury Homes At Singapore Most Reputable Private Residential Enclave

Hongkong, Hong Kong Island, Tai Tam, Jervois Rd, 31, 249080,

VERKAUFSPREIS

\$ 2100000.00

1130 qft 6 Zimmer 3 Schlafzimmer 3 Badezimmer

3 Etagen 3 qft Grundstücksfläche 3 Autostellplätze

**Fragrance Group Limited**

Fragrance Group Limited

Singapore, Singapore - Ortszeit

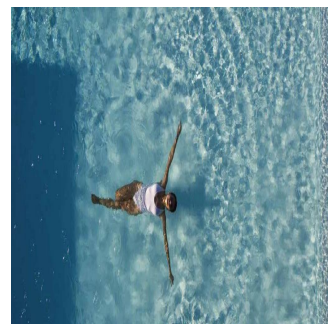
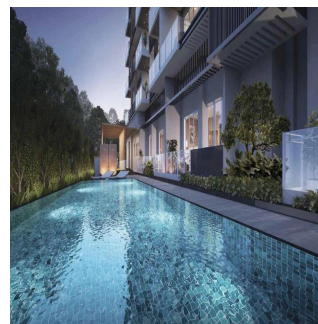
**+65 6346 6888**

Jervois Treasures, a laudable collection of 36 luxury homes at Singapore's most reputable private residential enclave. Nestled in District 10 where addresses include prestigious Nassim, Tanglin, Ardmore and Chatsworth, to name a few, Jervois Treasures offers the thrill of urban excitement that goes hand-in-hand with nature's tranquillity. EXPECTED T.O.P: Mar 2022

Verfügbar Von: 08.08.2019

Etage: 4 Etagen: 4 Baujahr: 2017 Pkw-Stellplätze: 4 Baujahr: 2017

Typ: Büro



Residents and investors will be pleased to know that amenities within proximity to Jervois Treasures are bountiful. Located along the city fringes, Jervois Treasures is just minutes' drive away to shopping paradise Orchard Road, Great World City, IKEA Alexandra, Vivo City, Sentosa and Universal Studios Singapore. For those working in town, be delighted to know that Jervois Treasures is within minutes' drive to major expressways (AYE, CTE, ECP) and CBD, MBFC, NUS, NUH, Science Park, Fushionpolis, Biopolis, Mapletree Business City. Closest MRTs include Tiong Bahru (EW17) and Redhill (EW18). Additionally, elite schools within 1-2 km of Jervois Treasures include Crescent Girls School, CHIJ St. Theresa's Convent, Radin Mas Primary School and Gan Eng Seng Primary School. Other prestigious schools in the area include River Valley Primary School, Raffles Girls' Secondary School, Hwa Chong Institution, Anglo-Chinese Junior College, Anglo-Chinese School (Independent). For toddlers, parents may consider sending them to the widely acclaimed Pat's Schoolhouse Tanglin, which is just minutes' drive from Jervois Treasures.

Ausstattung

ID	Eigenschaft ID
----	----------------

Ausseneinrichtung